

PEMS[®]

Simplified sampling valve with membrane for process tanks or lines and low viscosity liquids



Presentation

The PEMS sampling valve is used to take a sample of clear or low-viscosity liquid from a process line or a tank, in order to carry out quality and/or bacteriological tests. The valve is sealed by a membrane. Its hygienic design ensures that there are no retention areas (where bacteria can develop), and that it is easy to clean. Its hygienic qualities, as well as its ease of installation and maintenance, make it a market reference.

Key features

- Hygienic design with flush body
- Low cost of ownership and use
- Modular opening
- Ease of use and maintenance

Applications

- Sampling on a tank or transfer line of a clear or low-viscosity liquid (non-sticky, non-sugary and non-solidifying, except for the PEMS SEKU version)
- Equipment particularly suited to sampling products subject to quality and/or bacteriological tests

Technical features

Sizes: DN 6 and DN 10

Inlet fitting: Welding

Outlet fitting: Plain nozzle

CIP connection (option): Plain nozzle

Operating pressure: From 0.1 to 6.0 bar (0 to 10 bar for the PEMS SEKU version)

Operating temperature: From 0°C to 120°C

Withstands CIP/SIP: Up to 130°C for 20 to 30 minutes

Materials

- Parts in contact with the product: Stainless steel 1.4404 (316L)
- Other parts: Stainless steel 1.4307 (304L) or 1.4404 (316L)
- Sealing: VMQ (Silicone) membrane

Dimensions in mm

Sizes	A	B	D
DN 6 (elbow outlet)	48	70	24.5
DN 10 (elbow outlet)	47	71	34.5

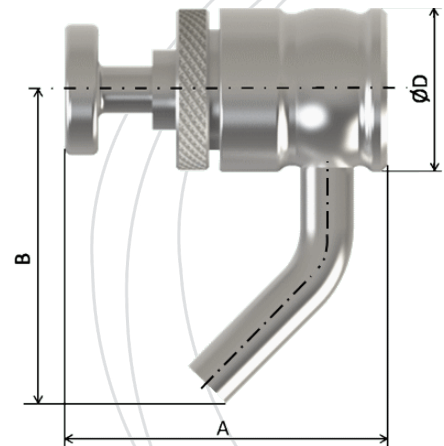

Options

- Additional inlet for CIP fluid flow
- VMQ (Silicone) or stainless steel cap(s)
- Other inlet connections: butt weld body, micro-clamp, clamp, female/male (DIN/SMS), 1/4, 3/8, 1/2 threaded, VARINLINE support, 60/30 oval flange (wine), etc.
- Other outlet connections: micro-clamp, clamp, 1/4, 3/8, 1/2, 3/4 thread, "alligator" type aseptic quick-fit coupling, etc.
- Other membranes: EPDM (Ethylene Propylene Diene Monomer), NBR (Nitrile rubber), FKM (Fluorocarbon rubber, eq. Viton®), FFKM (Perfluoroelastomer, eq. Kalrez®)
- PEMS delivered welded or clamped on SVX T-section (horizontal type PEH or vertical type PEV): please contact us
- Customised equipment: please contact us

Warranty

12 months as from the date of dispatch (except for special conditions)

Conformity

- Pipe fitting and tank compliant with Paragraph 4.3 of the PED 2014/68/EU
- Elastomer membranes compliant with FDA CFR 21.177.2600 and Regulation (EC) 1935/2004
- Optional depending on the elastomer: Membranes compliant with USP Class VI or ACS standard

Non-contractual document and visuals, subject to change without notice.

Only the commercial offer and the technical manual supplied with the equipment may be used for technical and legal purposes.